

# WALL MOUNTING:

## Continuous Hanger Bar (CHB) and Metal Plate (MP55Z) for TW and ATM

### APPLICATION:

For wall mounting mineral board panels with Z-clips.

### DESCRIPTON:

This installation technique uses a factory applied 5"x5" metal plate with "Z" punch out and a continuous hanger bar fastened to the wall. Installation is as follows:

1. Locate installation points of the CHB48S, by measuring the location of the "Z" punch on the back of each panel.
2. Install the CHB48S to the wall with appropriate fasteners for the wall condition and type. Fasten to studs when possible (fasteners not provided by G&S). Allow for 3/4" reveal.
3. Lift panels so "Z" clip punchouts are above wall mounted CHB48S. Lower the panel to engage clips. Verify all clips are engaged.
4. If Safety Clips are required to prevent lifting of panels, please contact G&S Acoustics.

### Wall Mounting Detail

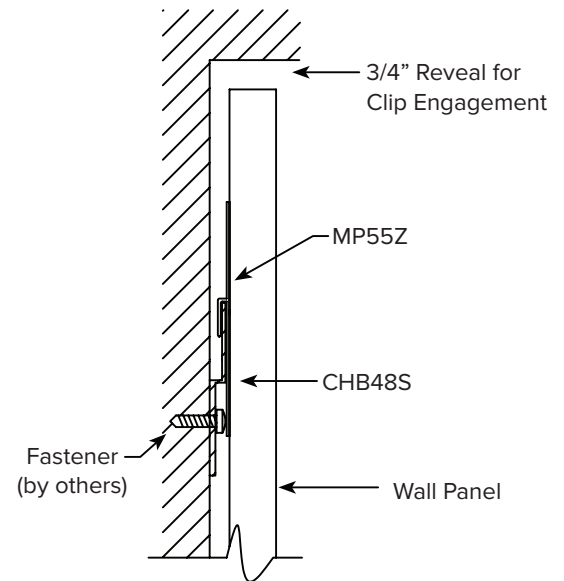

### CHB48S

Elevation

Side View

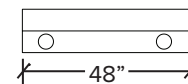

### MP55Z

Elevation

Side View

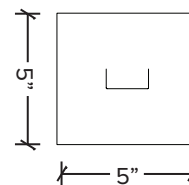

# WALL MOUNTING: Tackable Wall Panels (TW & ATM) - Transportation & Storing

## APPLICATIONS:

Transporting and storing mineral fiberboard panels (TW and ATM) once received.

## HANDLING AND STORAGE

TW and ATM mineral fiberboard panels must be stored indoors in a dry, climate controlled environment at all times. Exposure to moisture, excessive heat or humidity can cause panels to warp and/or stain.

Panels should be stored in a flat, fully supported, horizontal position and NOT on edge. It is recommended that 2 people carry each panel. Panel should be carried or moved on edge, be careful not to bend panel at any time. Clean white gloves are recommended when handling TW and ATM panels.

When transporting TW and ATM panels support bars should be attached to the cart to fully support the panels, while on edge and to prevent bowing. See illustration below:

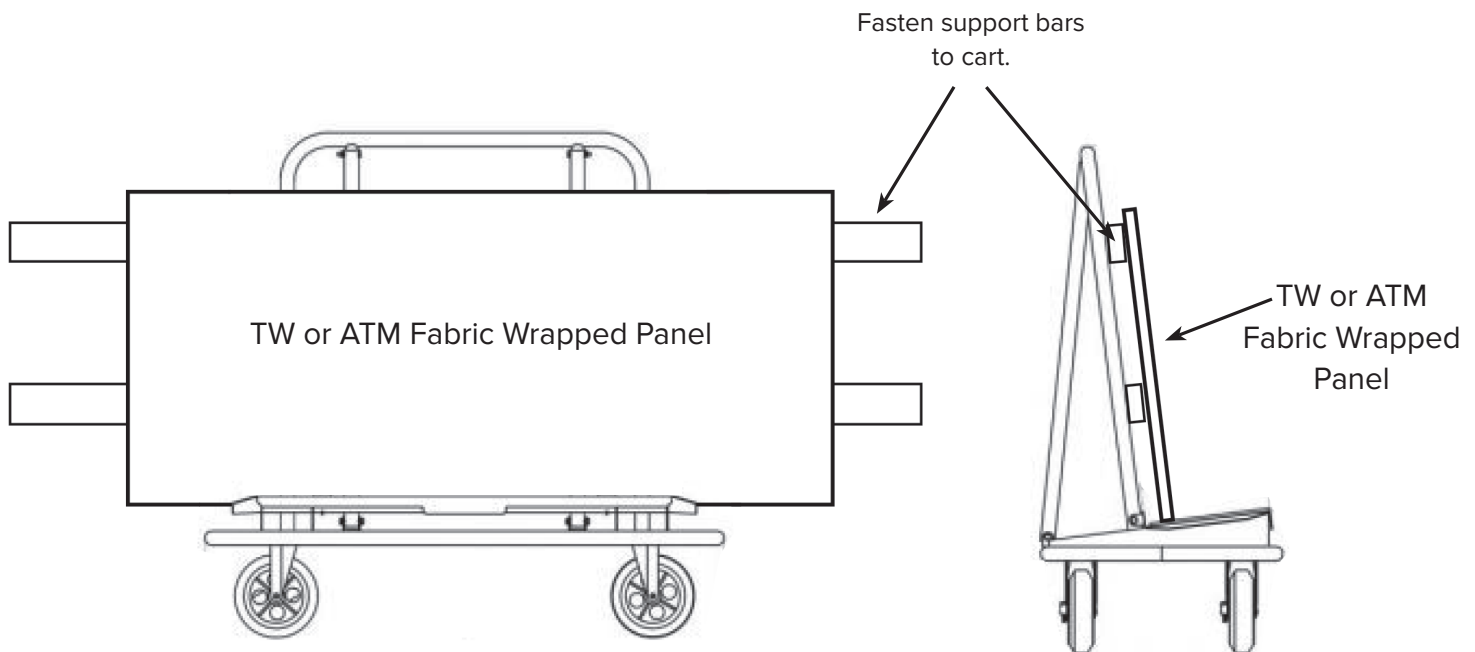

# Standard Locations for Metal Plates (MP55Z) on TW & ATM Panels

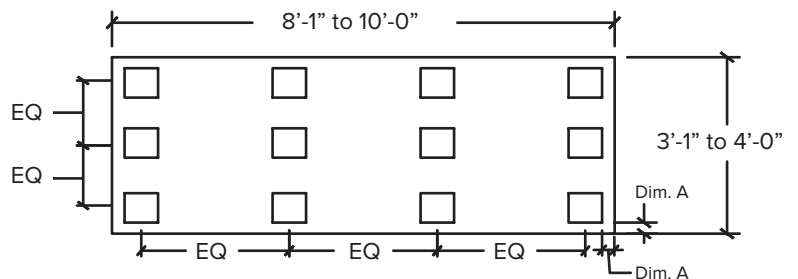
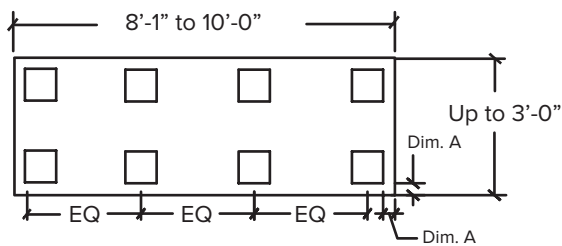
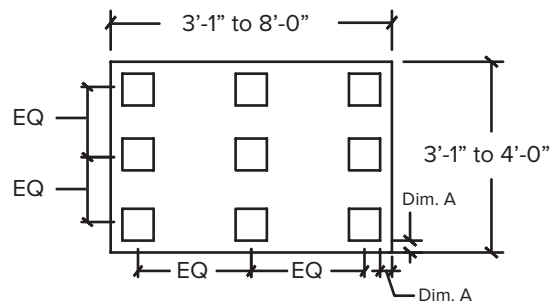
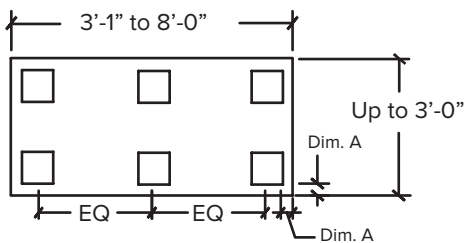
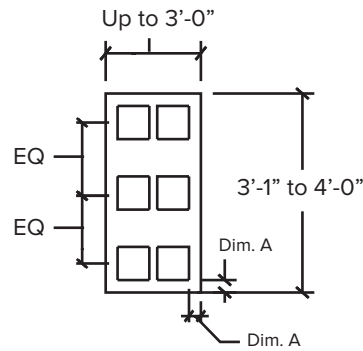
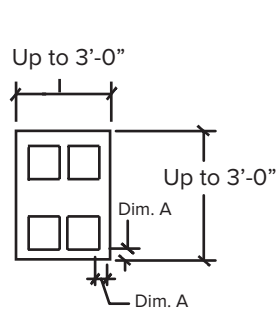

**Dim. A** 3" from edge

**Note** 3'-0" or under, remove center row