

BAFFLE GROMMET (BG)

Locations-PVC/Nylon Baffles

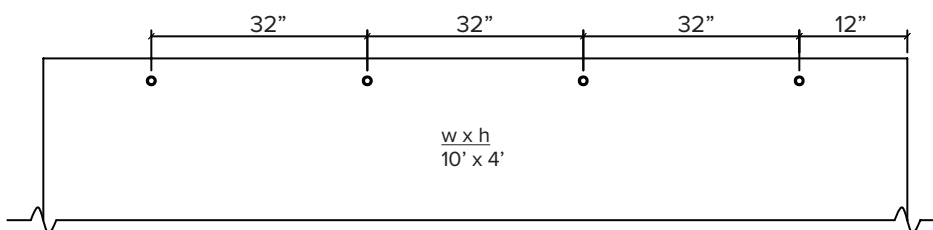
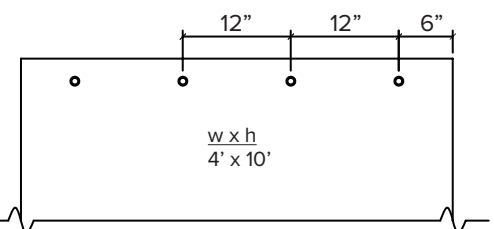
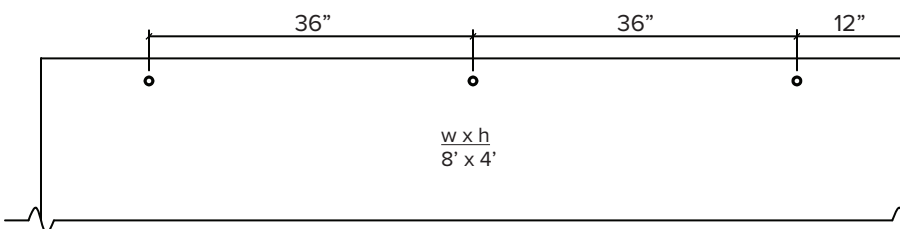
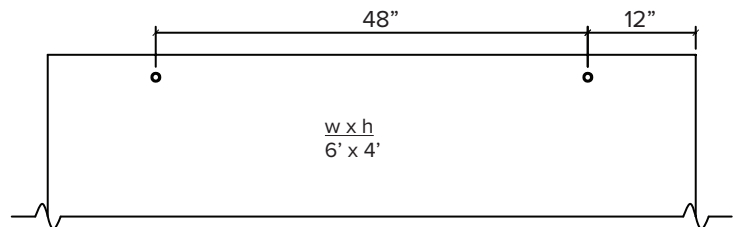
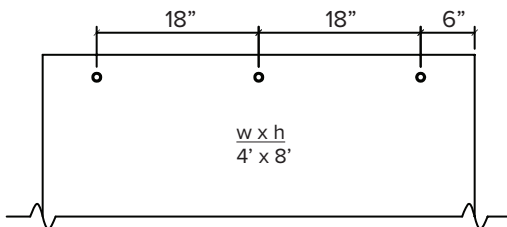
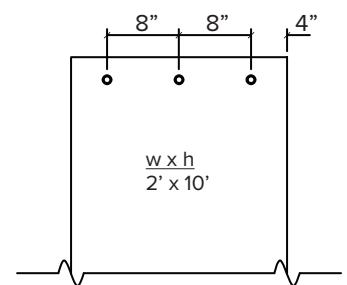
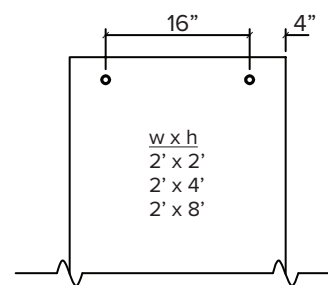
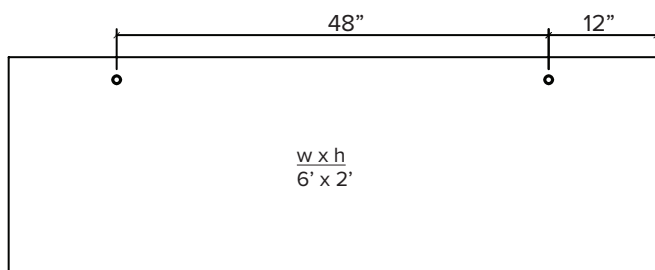
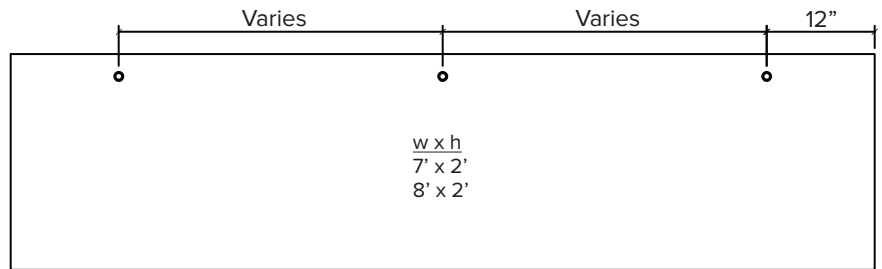
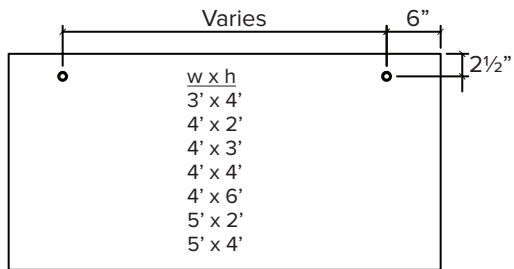

General Notes:

- 1) Store products in a cool, dry, and temperature controlled interior location not less than 50°F prior to, during, and after installation.
- 2) Store products out of direct UV sunlight.
- 3) Store and protect products from the elements and from damage.
- 4) Sailcloth is not recommended for high humidity or high U.V. areas.
- 5) Suspension hardware is not to be pre-installed.
- 6) Some wrinkling and puckering, due to the nature of these products, is common and unavoidable.
- 7) Baffles are constructed from fiberglass with a soft and flexible core. Grommet locations may vary.
- 8) Do not subject acoustical products to critical edge lighting without first consulting manufacturer.

BAFFLE GROMMET (BG)

Locations - PVC/Nylon Baffles with Flap

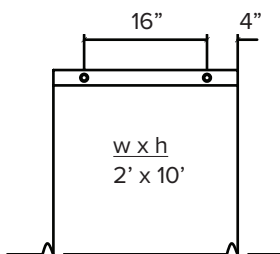
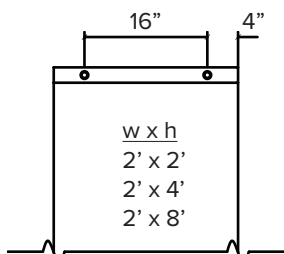
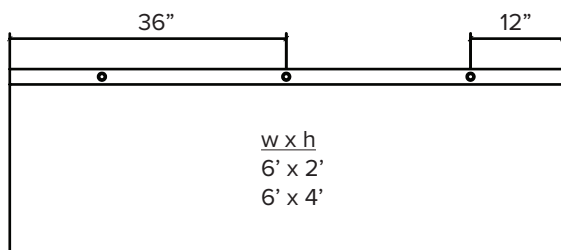
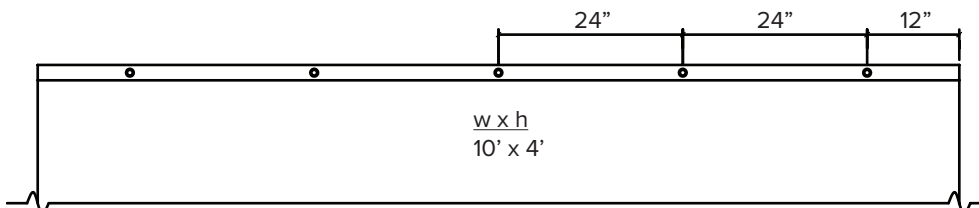
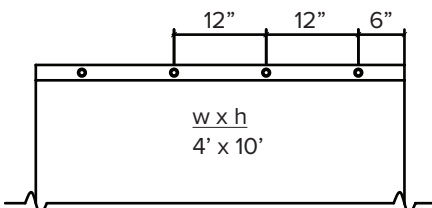
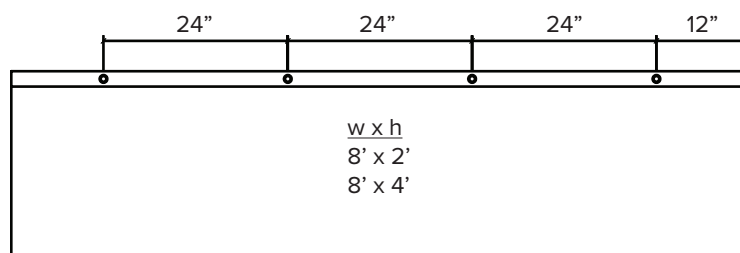
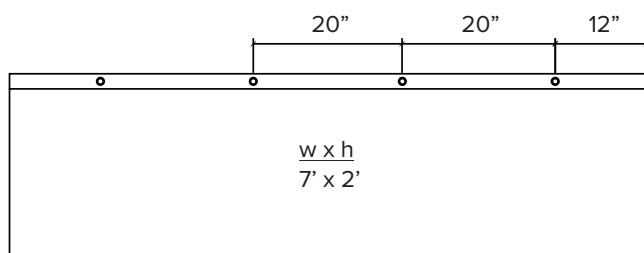
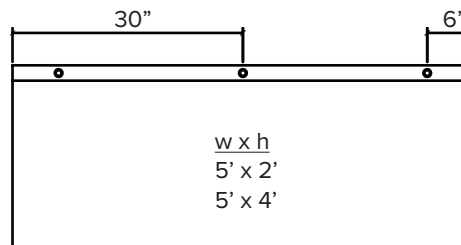
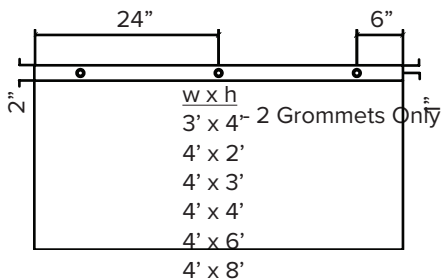

General Notes:

- 1) Store products in a cool, dry, and temperature controlled interior location not less than 50°F prior to, during, and after installation.
- 2) Store products out of direct UV sunlight.
- 3) Store and protect products from the elements and from damage.
- 4) Sailcloth is not recommended for high humidity or high U.V. areas.
- 5) Suspension hardware is not to be pre-installed.
- 6) Some wrinkling and puckering, due to the nature of these products, is common and unavoidable.
- 7) Baffles are constructed from fiberglass with a soft and flexible core. Grommet locations may vary.
- 8) Do not subject acoustical products to critical edge lighting without first consulting manufacturer.