

# Quik-Image (QI) Wall Installation

## APPLICATION:

For wall mounting Quik-Image with adhesive on painted or primed drywall.

## TOOLS NEEDED:

Heavy Bodied Water-Based Adhesive, Utility Knife, Drill, 1/4" bit

## MOUNTING HARDWARE:

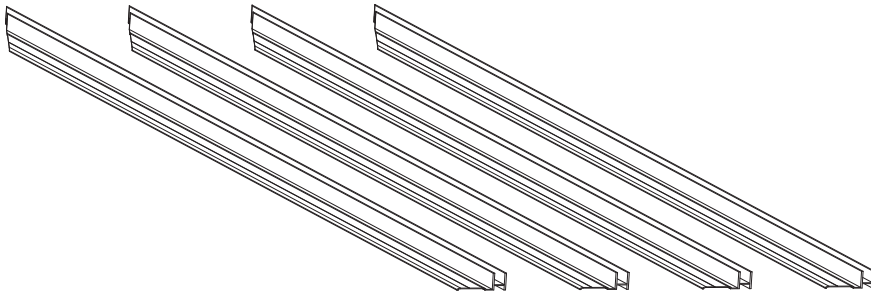

Quik-Image Frames

## INSTALLATION INSTRUCTIONS:

1. Drill 1/4" holes into the Quik-Image frame every 16" on center. Mount Quik-Image frame to wall with fasteners (by others).
2. Cut acoustic panel to size. Then bevel-cut back edges of acoustic panel, so it clears the frame.
3. With a putty knife, size the back of the acoustic panel by applying a thin coating of adhesive approximately 4"x4" square, 18" on center across the back of the panel. **Note:** Use only heavy-bodied, water-based adhesive (WW Henry 440 Cove Base Adhesive). Place adhesive dabs, about the size of a large egg, centered on each 4"x4" sized area. Position the panel within the frame.
4. To ensure the acoustic panels are evenly secured, apply pressure with hands moving them from center to outer edge of each panel.

## Step 1

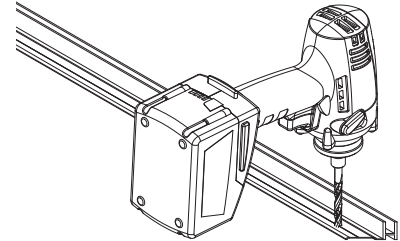

## Step 2

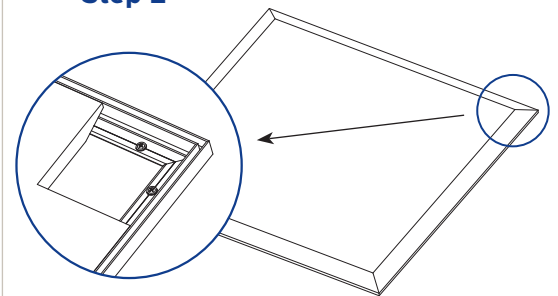

## Step 3

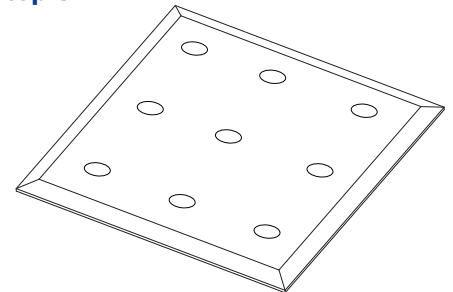

# Quik-Image (QI) Wall Installation

## INSTALLATION INSTRUCTIONS:

5. To install the fabric panel, first, press silicone edge of the fabric panel into the corners of the frame approximately 6" in each direction.
6. Next, press the silicone edge at the center of each side of the frame.
7. Working in centers again, go back and press the silicone edge once again on each side previous center, on all sides. Repeat this process until the silicone edge is pressed approximately every 6 inches apart.
8. Pressed remaining silicone edges into the frame, use your finger to smooth fabric edges.

**Note:** Fabric tab should remain untucked in the event the fabric panel needs to be removed.

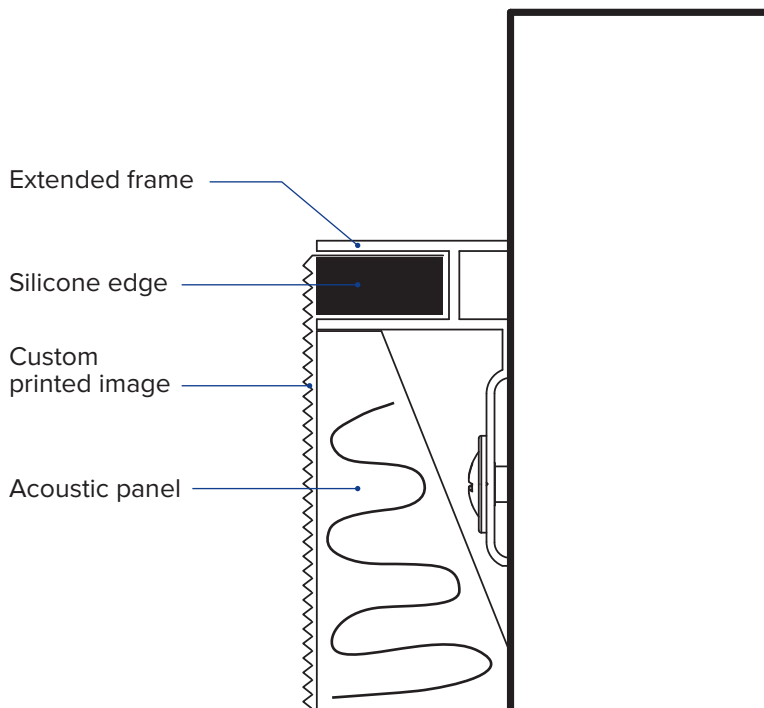

## Step 5

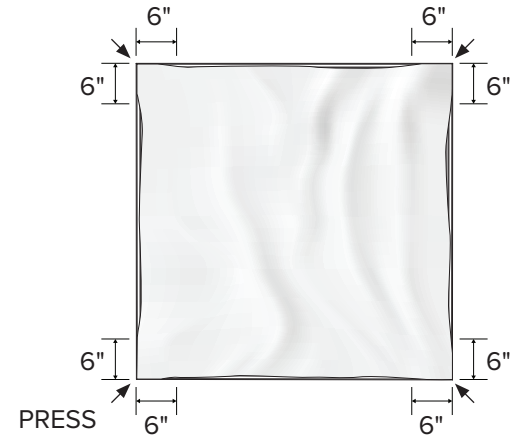

## Step 6

