

Top Clamp - Ceiling Installation

APPLICATION:

For ceiling mounting aCapella Structures using a Top Clamp.

TOOLS NEEDED:

(1) Slotted Screwdriver

MOUNTING HARDWARE:

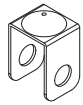

Top Clamp

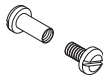

Threaded Through Bolt (TTB)

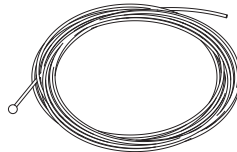

10' Cable with Swage

INSTALLATION INSTRUCTIONS:

1. Each aCapella Structures ships flat as individual panels to be assembled on-site.
2. Each Panel will have a sticker indicating the top edge of the panel and the part letter (A, B, C). Be sure to install with all stickers facing the same direction and follow lettering schematic attached.
3. Sort panels A, B, C, on a clean work surface making individual piles of each labeled panel.
4. Start with placing the two A Panels with holes parallel to each other and insert the 2nd notch of the B Panel into the first notch on the A Panel. Push the B Panel onto the A Panel at the opposing notches, push down until fully seated and tops of panels are aligned.
5. Next, insert the 2nd notch of another B Panel into the first notch on opposite end of the A Panel. Push the B Panel onto the A Panel at the opposing notches, push down until fully seated and tops of panels are aligned.
6. Continue inserting all B Panels into the two A Panels.
7. Insert the C Panels perpendicular into the B Panels at the opposing notch, be sure to push down until fully seated and tops of panels are aligned.
8. Continue inserting all C Panels into the B Panels, be sure to push down until fully seated and tops of panels are aligned.

Steps 2-3

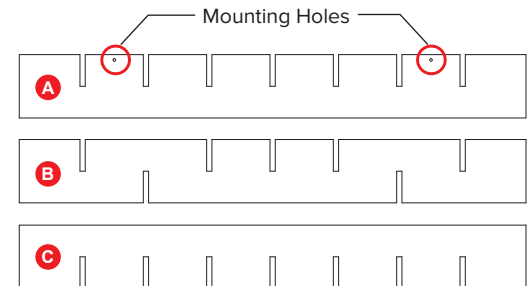

Step 4-5

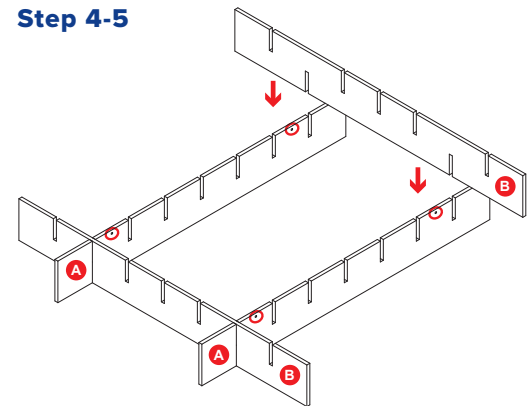

Steps 6-8

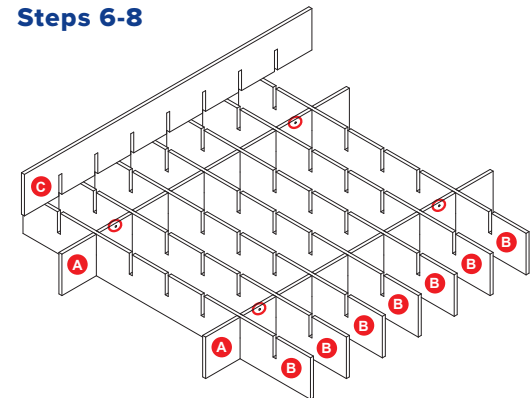

INSTALLATION INSTRUCTIONS:

9. Insert the cable up through the top hole in each Top Clamp. Pull cable through Top Clamp until the swage sits snug inside Top Clamp.
10. Slide Top Clamps onto A Panels with holes, aligning Top Clamp hole with pre-drilled holes in the A Panels. Attach using the Threaded Through Bolts.

The Structures Panels are now ready to hang. Use appropriate fasteners and hardware to install the baffles from the structure. Structures Panels must be hung parallel to the ceiling, not at an angle. Remove all stickers before hanging.

HANDLING AND STORAGE

aCapella panels must be stored indoors in a dry, climate controlled environment at all times. Exposure to moisture, excessive heat or humidity can cause panels to warp and/or stain.

Panels should be stored in a flat, fully supported, horizontal position and NOT on edge. It is recommended that 2 people carry each panel. Panel should be carried on edge, being careful not to bend panel at any time. Clean white gloves are also recommended when handling aCapella panels.

Step 9

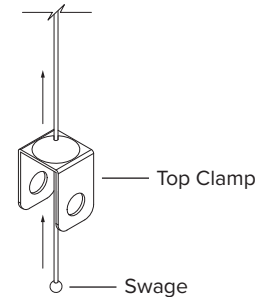

Step 10

